

WALL LEGEND	
	EXISTING WALL/CONSTRUCTION
	DEMOLISHED WALL/CONSTRUCTION
	NEW WALL/CONSTRUCTION

- GENERAL NOTES**
- ALL WORK SHALL BE IN ACCORDANCE WITH ALL CURRENT LOCAL, STATE, AND FEDERAL BUILDING CODES
 - PROVIDE MIN. 1/2" THICK WATER RESISTIVE GYP. BD. AT ALL WALLS OF KITCHEN WET WALLS
 - PROVIDE EXHAUST VENT FOR ALL TOILET ROOMS DIRECTLY TO THE EXTERIOR
 - A MONITORED FIRE ALARM SYSTEM SHALL BE PROVIDED THROUGHOUT THE ENTIRE BUILDING.
 - NEW A/C SYSTEM TO BE INSTALLED BY MECHANICAL SUB-CONTRACTOR
 - ALL INTERIOR FINISHES BY OWNER
 - SEE KITCHEN DESIGN PLAN FOR CABINET & APPLIANCE SPECIFICATION & LOCATION
 - EXISTING DOORS, TRIMS, & CASING TO BE REUSED IN NEW LOCATIONS. (SEE DOOR SCHEDULE).
 - PATCH, REPAIR, INFILL HARDWOOD STRIP FLOORING AS REQ'D DUE TO LAYOUT RECONFIGURATION. (APPROX. 32 SF)
 - ALL DIMENSIONS ARE TO FACE OF STUD, UNLESS NOTED OTHERWISE.

DOOR SCHEDULE

DOOR NUMBER	DESCRIPTION	WIDTH	HEIGHT	COMMENTS
LEVEL 0				
002	SINGLE FLUSH	2' - 6"	6' - 8"	
003	SINGLE FLUSH	2' - 6"	6' - 8"	
LEVEL 1				
103	DOUBLE FLUSH GLASS	5' - 0"	7' - 0"	
LEVEL 2				
204	SINGLE FLUSH	2' - 4"	6' - 8"	REUSE EXISTING DOOR
205	SINGLE POCKET	2' - 4"	6' - 8"	REUSE EXISTING DOOR
206	SINGLE FLUSH	2' - 6"	6' - 8"	REUSE EXISTING DOOR
206.1	SINGLE FLUSH	2' - 0"	6' - 8"	REUSE EXISTING DOOR
207	SINGLE FLUSH	2' - 6"	6' - 8"	REUSE EXISTING DOOR

- DOOR NOTES:**
- ALL DOORS ARE TO BE LOCATED EITHER 4" FROM ADJACENT WALL OR CENTERED ON THE WALL UNO.

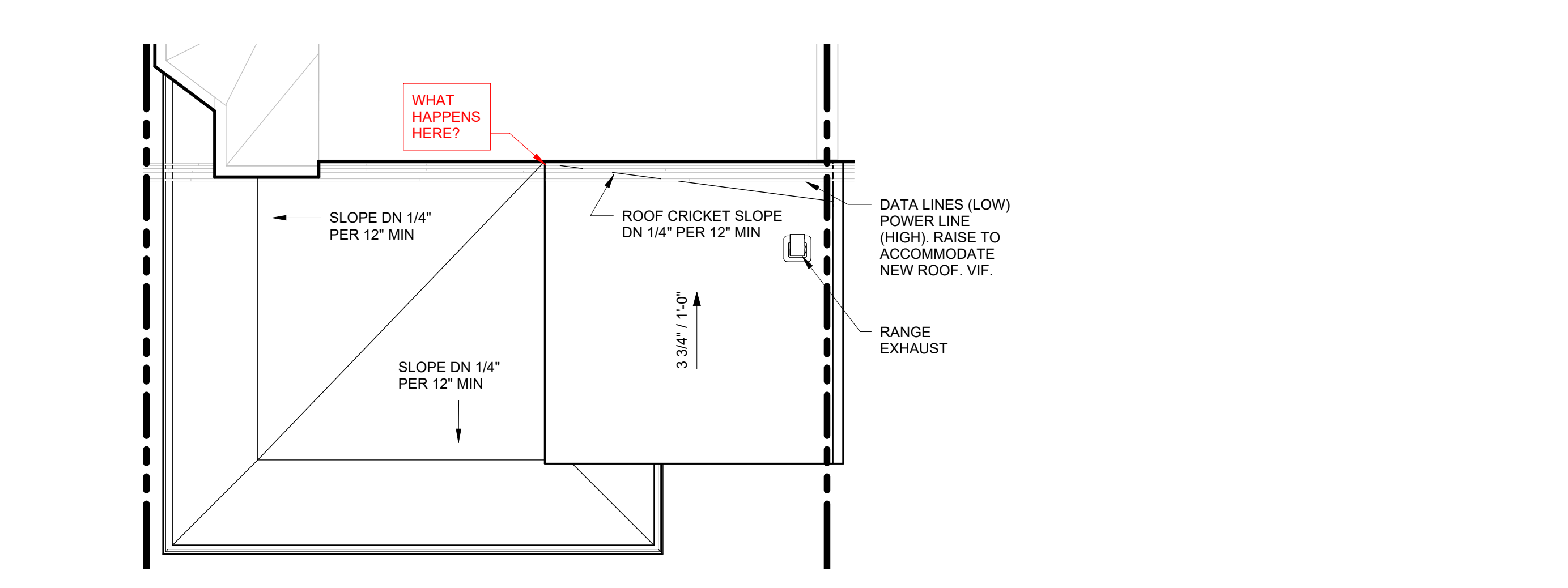
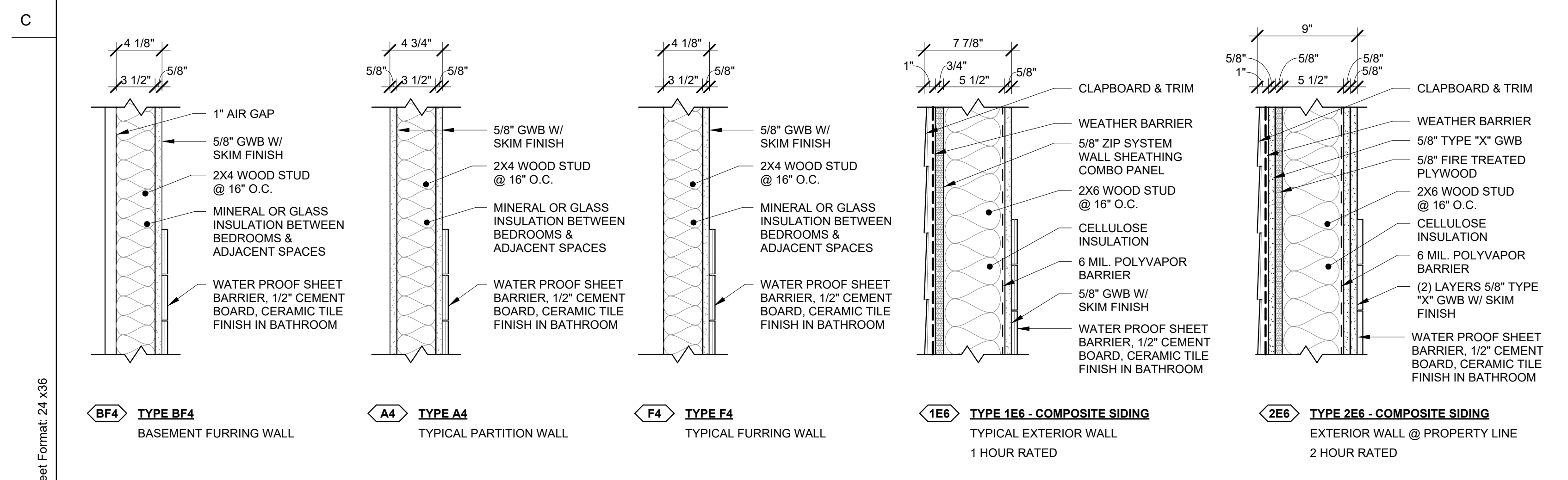

0 FLOOR PLAN - BASEMENT 1/4" = 1'-0"
1 FLOOR PLAN - FIRST FLOOR 1/4" = 1'-0"
2 FLOOR PLAN - SECOND FLOOR 1/4" = 1'-0"
3 ROOF (RIDGE) 1/4" = 1'-0"

Prepared by: **CADENCE** ARCHITECTURE + DESIGN LLC
 3110 W. Penn Street Philadelphia, PA 19129
 M. 617.233.6554 E. m@cadencead.com

Project Address: **CLANCY RESIDENCE, 223 DURAND STREET, PHILADELPHIA, PA 19119**

Drawing Title: **FLOOR PLANS**

Project # 25-104

Drawn By: AH Reviewed By: MH

Scale: As indicated Date: 04/03/2026

Drawing #: **A100**

